

MORRIS BRISBIN ROAD TIF DISTRICT  
 PART OF SECTIONS 24, 25, 26 AND 35  
 TOWNSHIP 34 NORTH, RANGE 7 EAST OF THE 3RD P.M.  
 CITY OF MORRIS, GRUNDY COUNTY, ILLINOIS

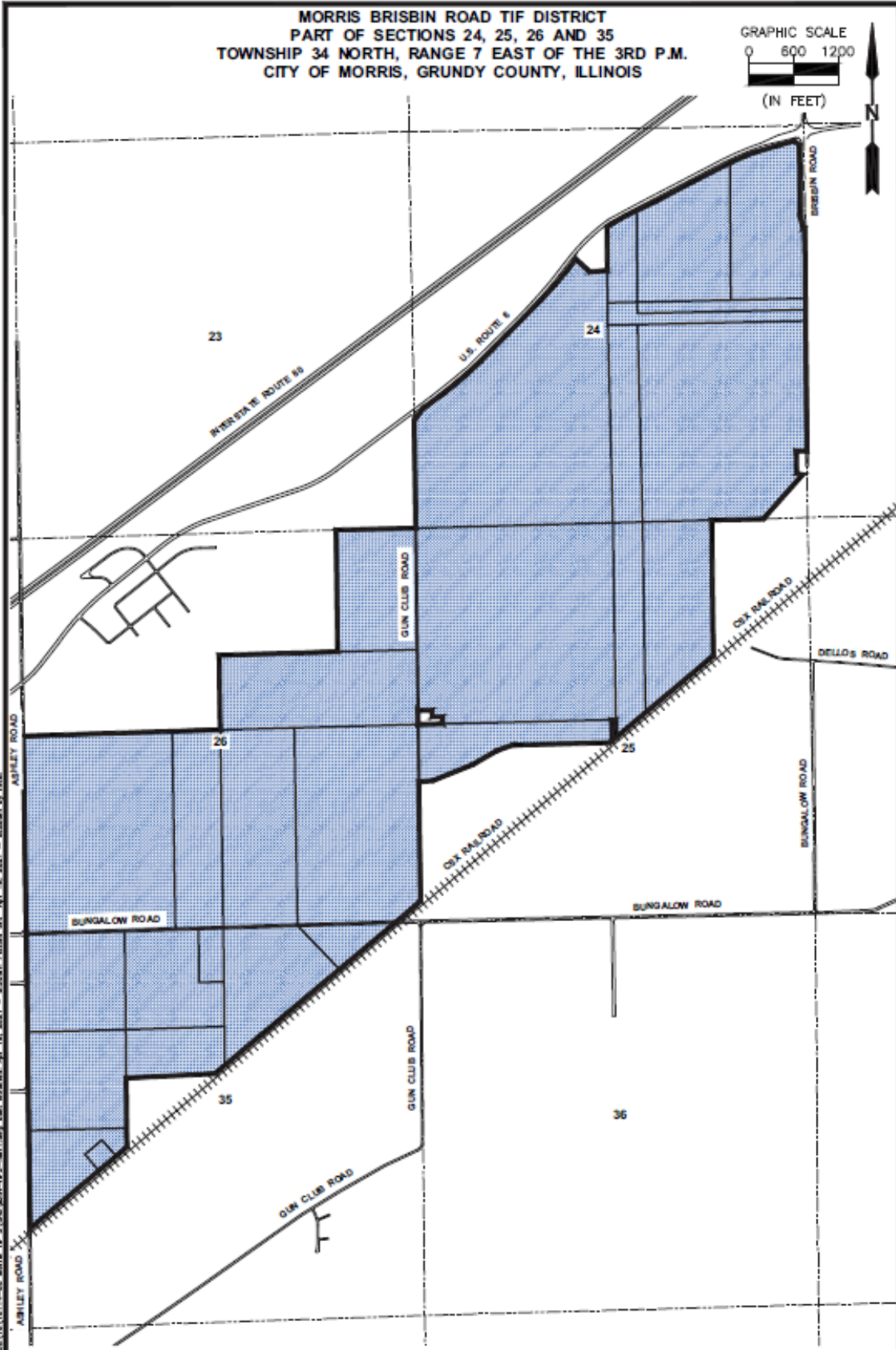
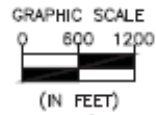

CHAMLIN & ASSOCIATES, INC. © 2020  
 Drawing Name: R:\MSO\1418114-00 Morris TIF 2\040\031-187-187.dwg Last Modified: Apr 16, 2021 - 8:35am Plotted on: Apr 19, 2021 - 8:33am by: JMS

	SCALE: AS NOTED	MORRIS TIF III	
	DATE: 04/19/21	DRAWN BY: NET	FILE NO.: 13585